

Date: Thursday, September 27, 2018  
From: Ken Lobeck, Funding Programs Lead, 503-797-1785  
Subject: Attachment 1 to the October 2018 MTIP Formal Amendment Staff Report – Project Location Maps

---

## BACKGROUND

Available project location maps and OTC request letters are included in this attachment to the staff report for reference for their applicable projects. Maps and/or OTC letters are included for:

- Key 18021 – Portland: East Portland Active Transportation to Transit
- **Key 23171 - I-5 and I-205: Portland Metropolitan Value Pricing Program**
- Key 19786 – I-205: Stafford Rd to OR99E
- Key 20488 – North Dakota Street: Fanno Creek Bridge
- **Key 20784 – Vision Around the Mountains Planning Study**

### Key 18021

East Portland Active Transportation to Transit (Portland)

East Portland Access to Transit: 130s Bikeway Route Map

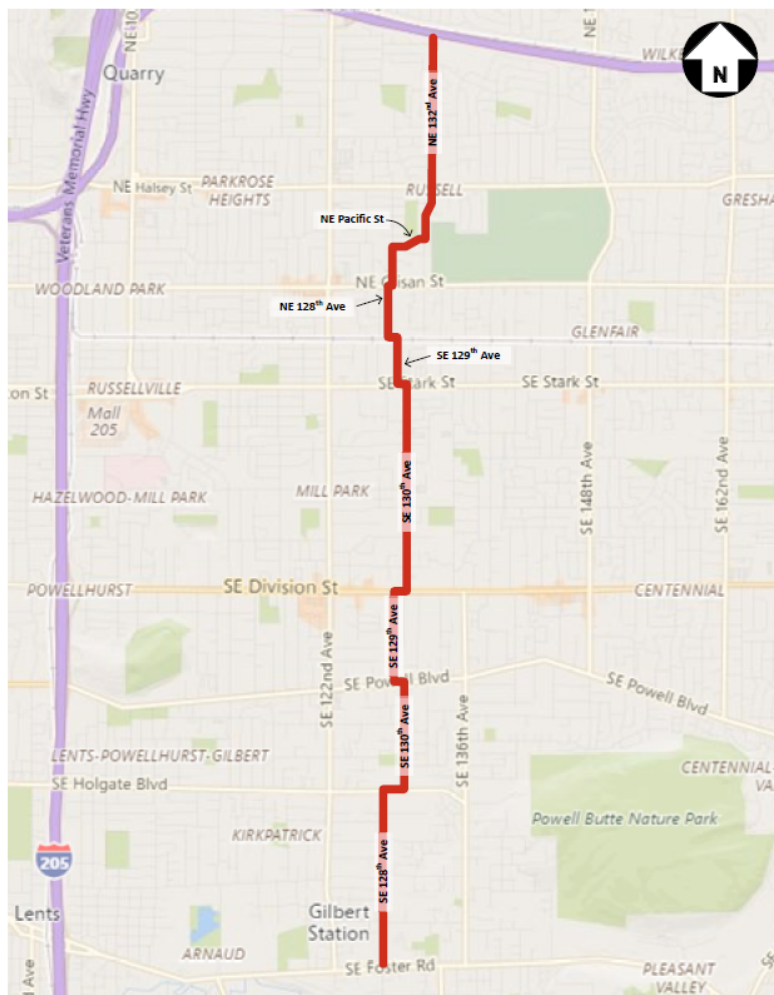

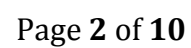

**Key 23171**  
**I-5 and I-205: Portland Metropolitan Value Pricing Program**

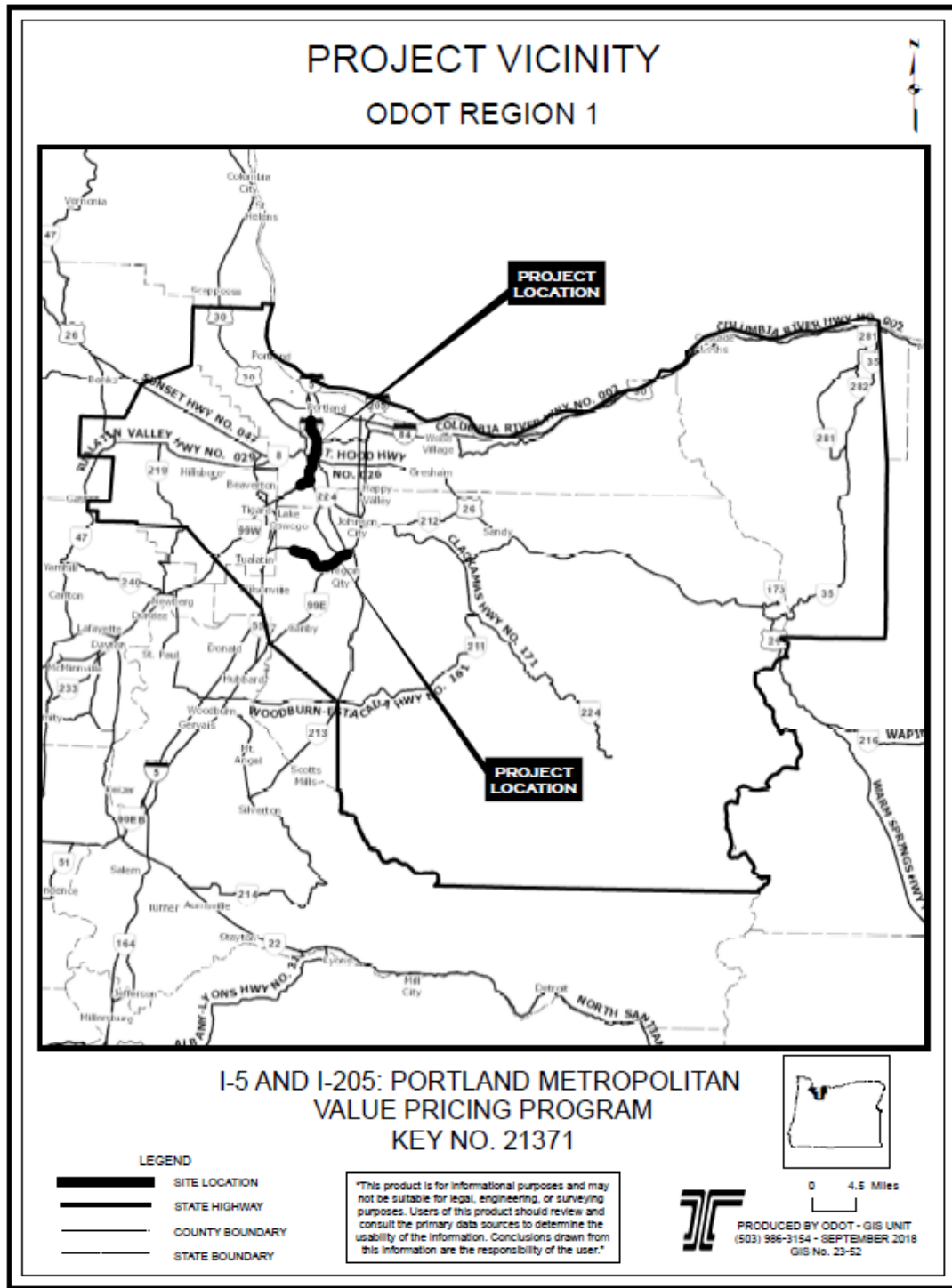

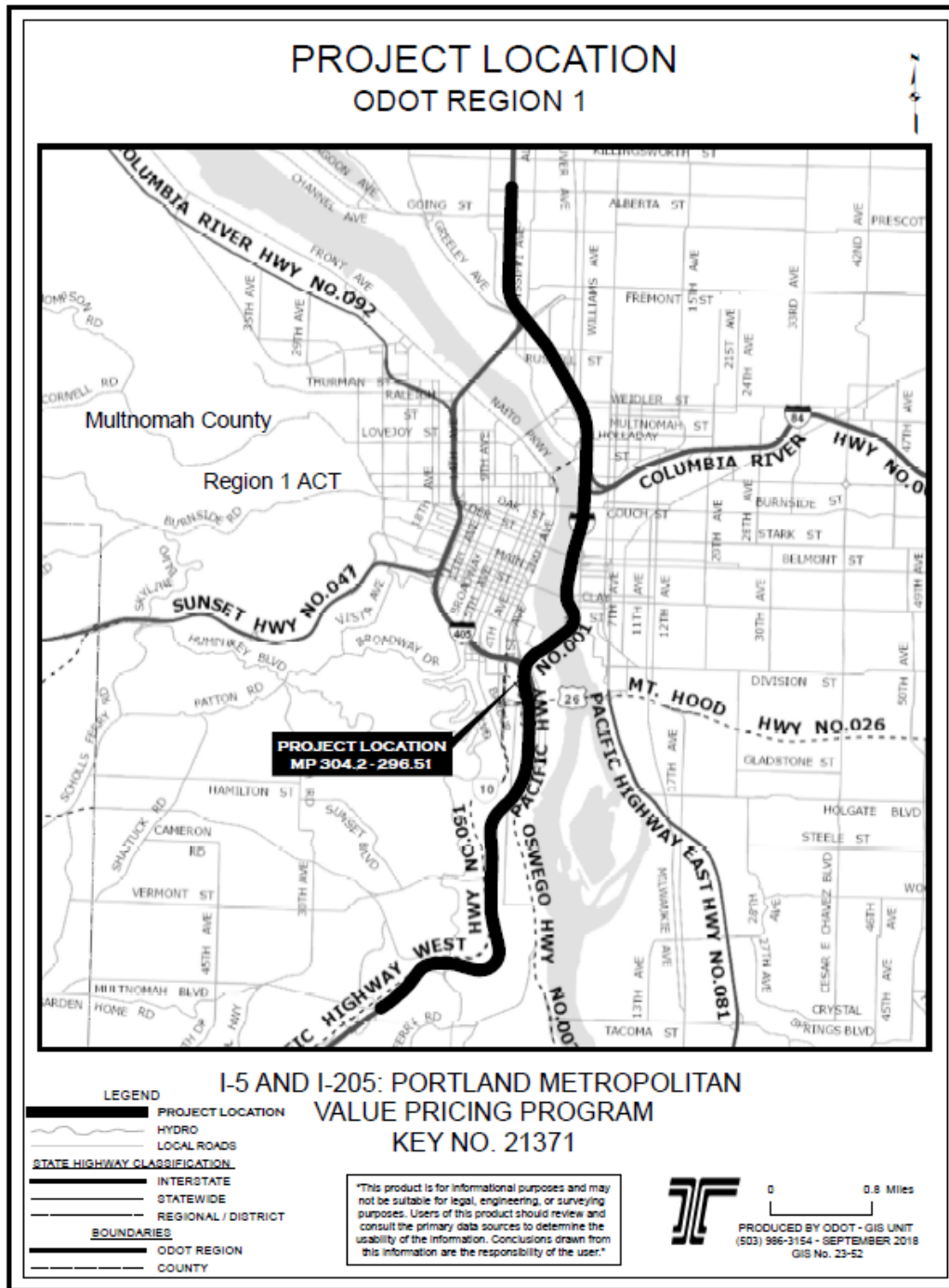
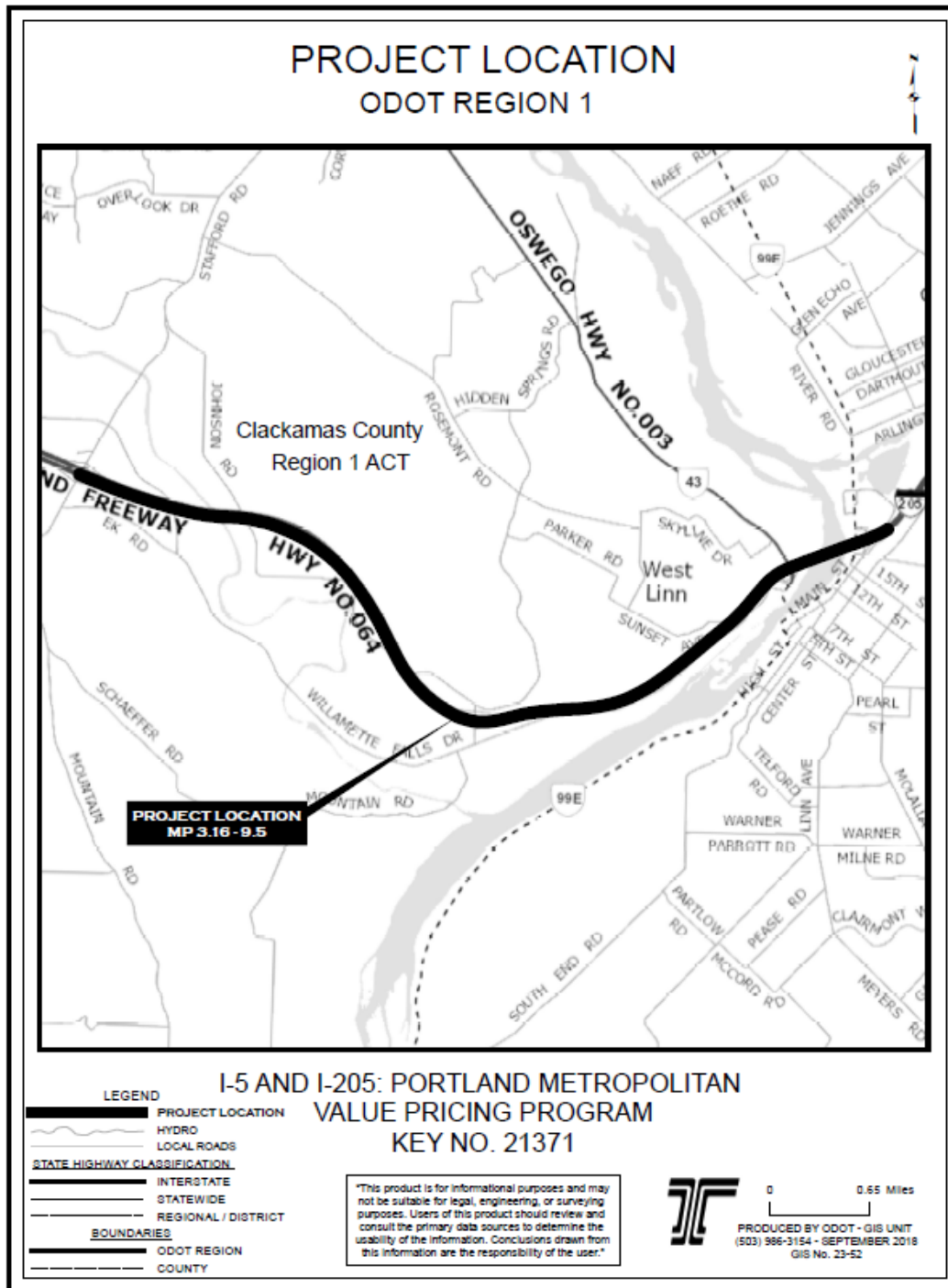
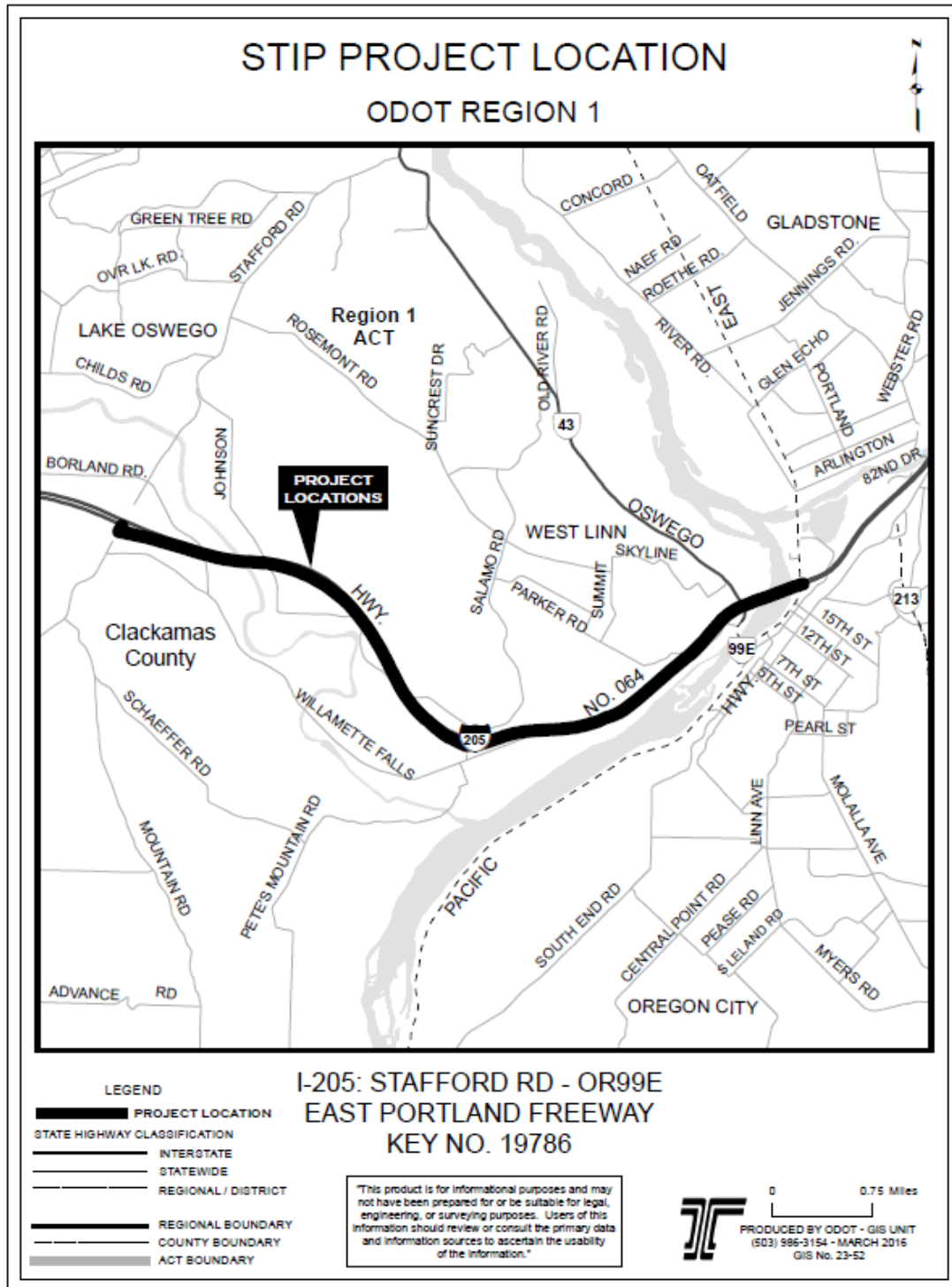

fig1\_resource\gwork\GIS23\_52\_OTC\_maps\_and\_graphics\OTC\_MAP\DOTC\_18\_MAPS



g:\resources\gwork\GIS23\_52\_OTC\_maps\_and\_graphics\OTC\_MAPS\OTC\_18\_MAPS

**Key 19786**  
I-205: Stafford Rd to OR99E



g:\resources\glenn\GIS\23\_52\_OTC\_maps\_and\_graphics\OTC\_MAPS\OTC\_16\_MAPS\REGION1.MXD



Attachment 1

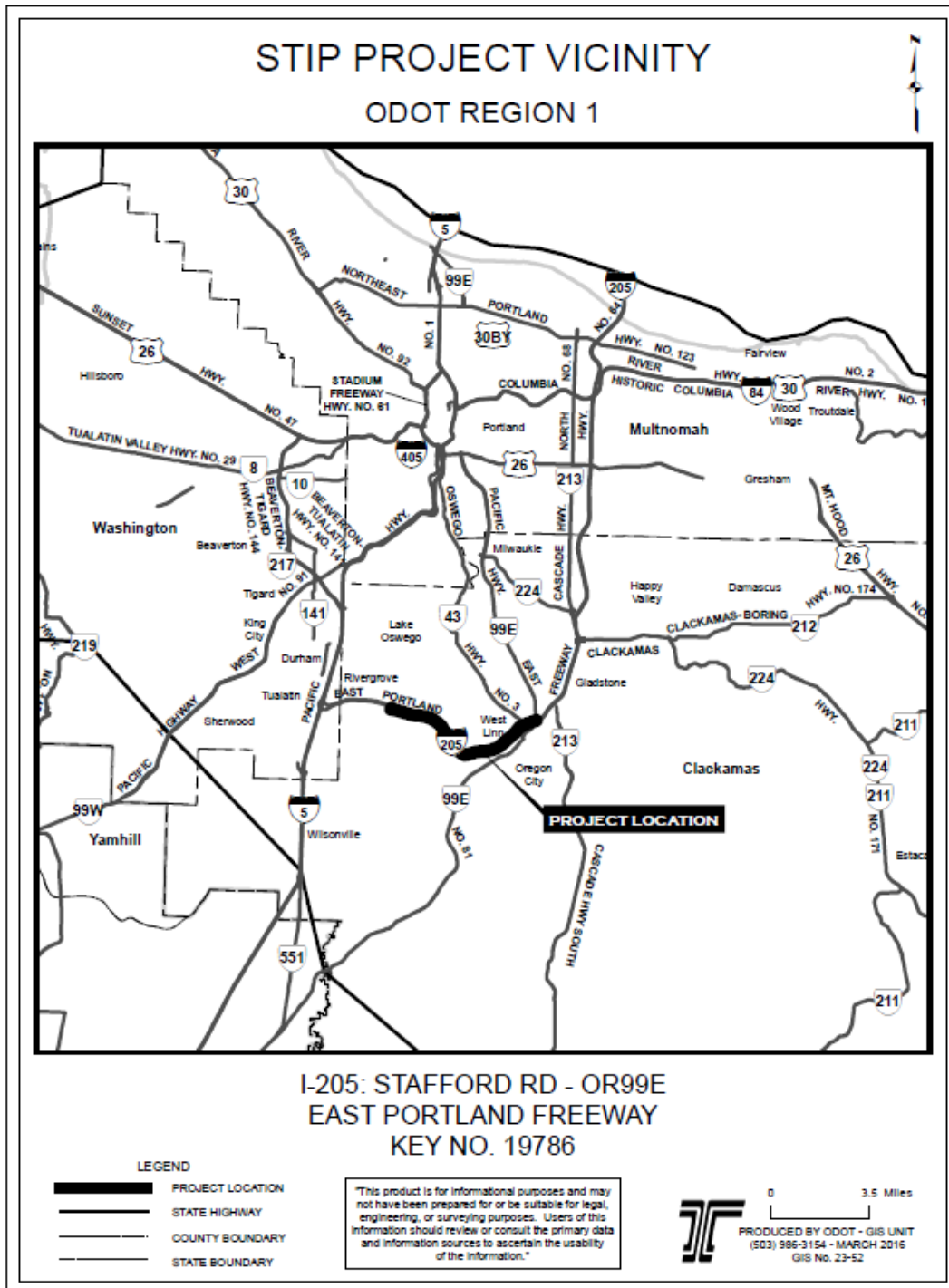

igls\_resources\gis\work\GIS23\_52\_OTC\_maps\_and\_graphics\OTC\_MAP\OTC\_16\_MAP\REGION1.MXD

**Key 20488**  
**North Dakota Street: Fanno Creek Bridge**

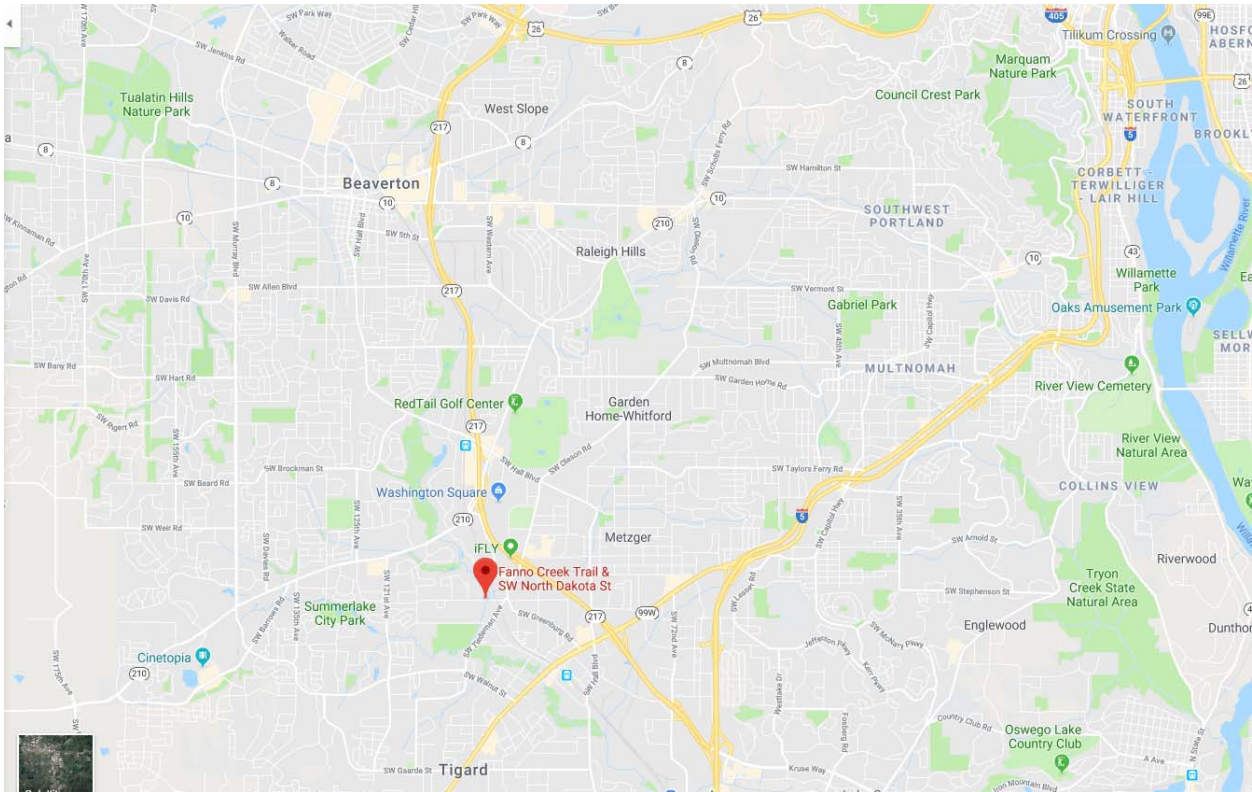
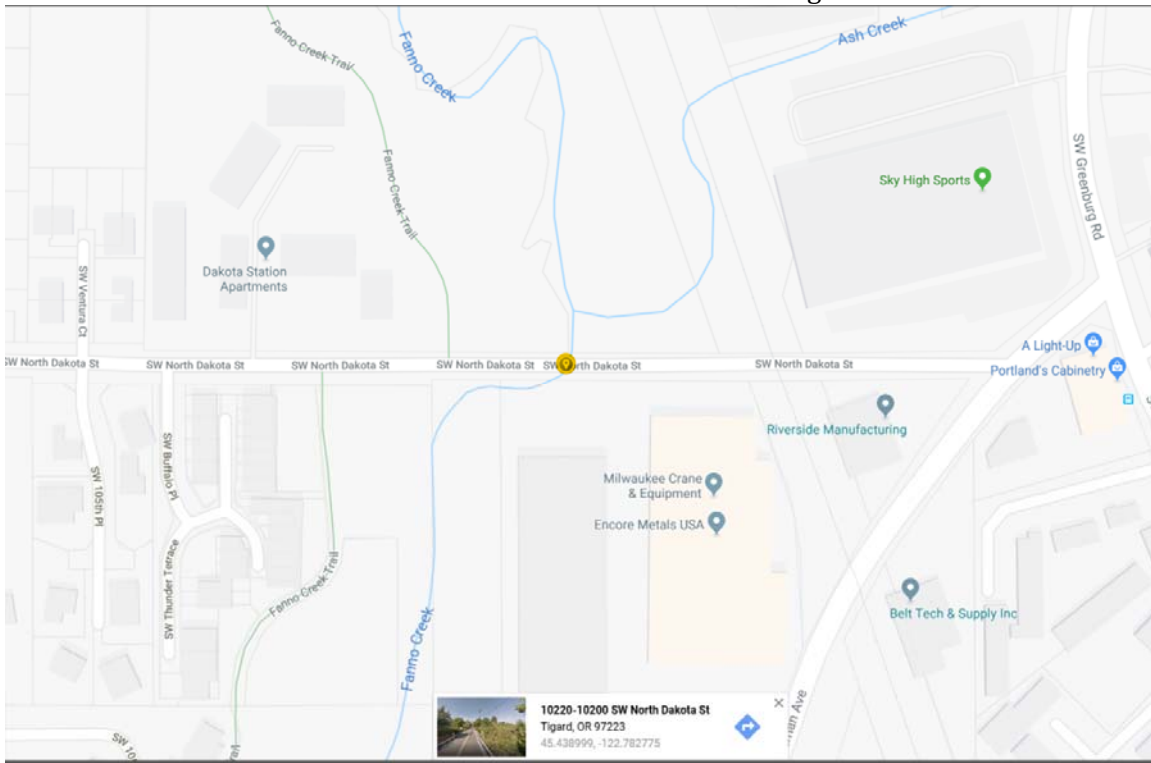



**Key 20784**  
Vision Around the Mountains Planning Study

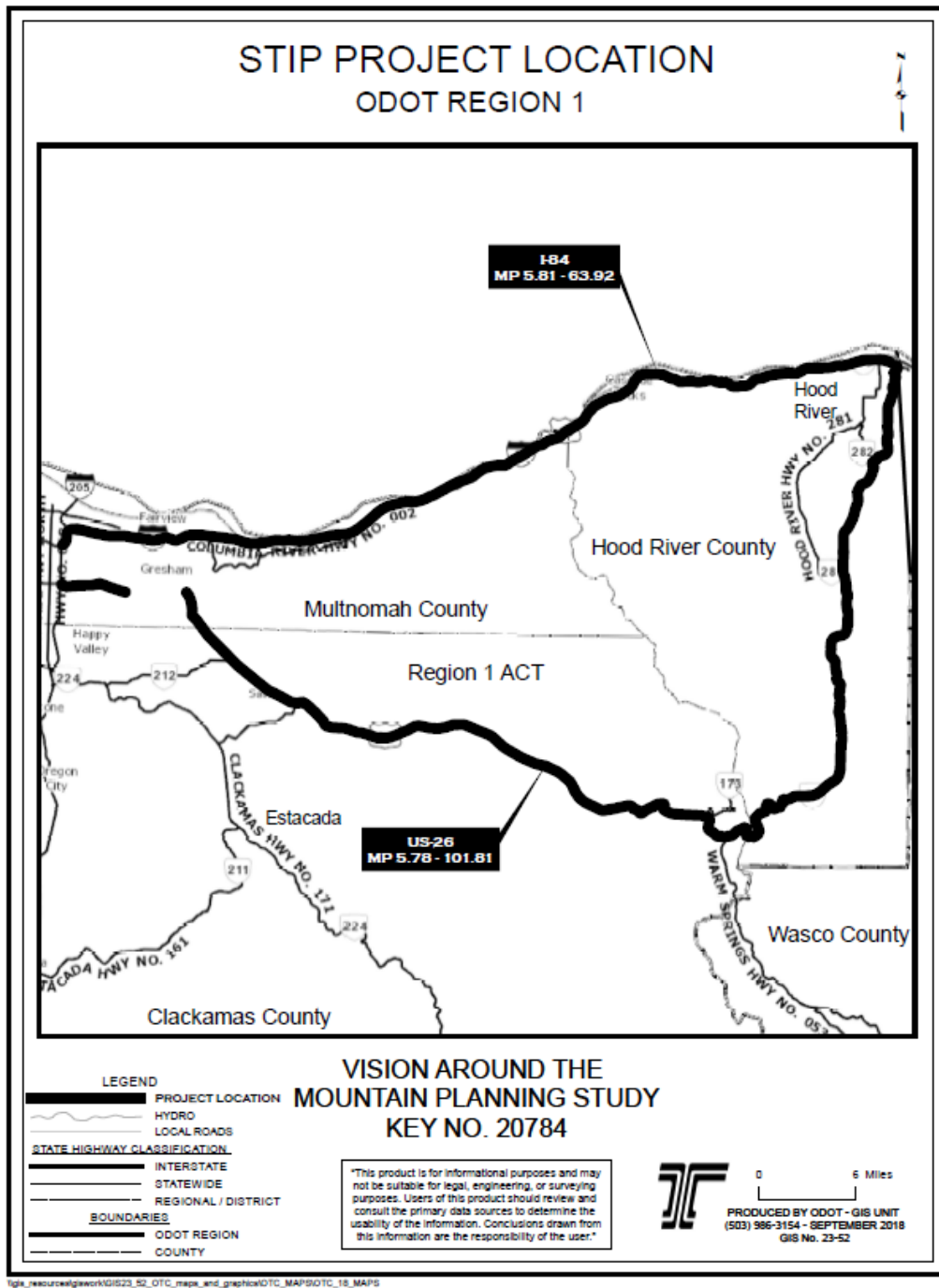

fgis\_resource\gwork\GIS23\_52\_OTC\_maps\_and\_graphics\OTC\_MAPS\OTC\_18\_MAPS

